



Byggtræff 2019 Island

Sigtryggur Veigar Herbertsson

Ráðgjafarmiðstöð Landbúnaðarins



Dairy productions

- Dairyfarms in Iceland in total 557
- Average size 48,2 cows (2 – 244)
13 farms with 120+ cows
- Yield 6.273 (2.128 – 8.427)
- Grant for living milking cow 12,71 €/year
- Farmers gets 0,65 € for milk
- Grants for quota milk 0,25 €
 - Total 0,90 € for milk
 - Shop price 1,13 €
- Quata market is frozen at the momemt, (max price 1,3 €)

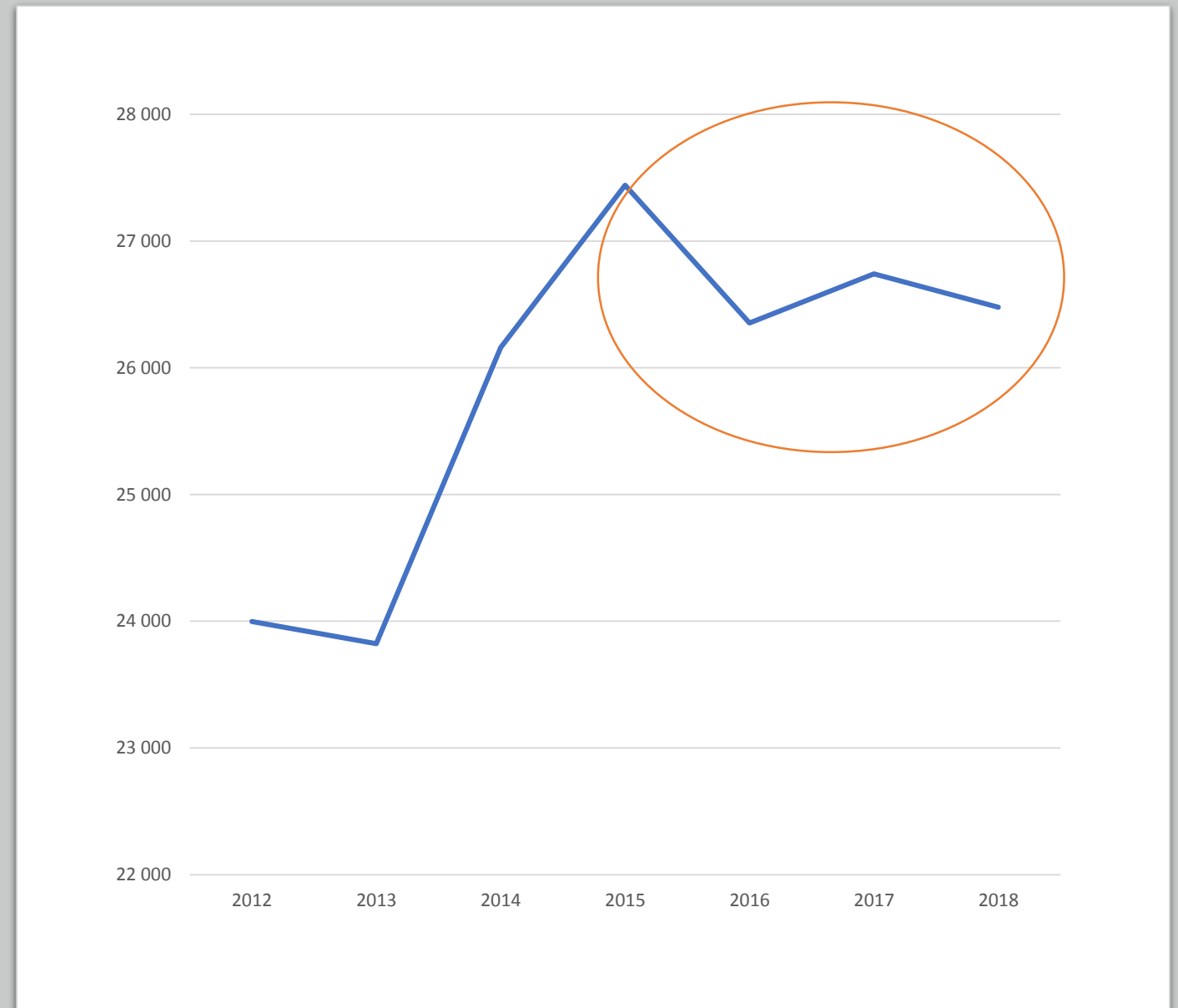

Cows and production

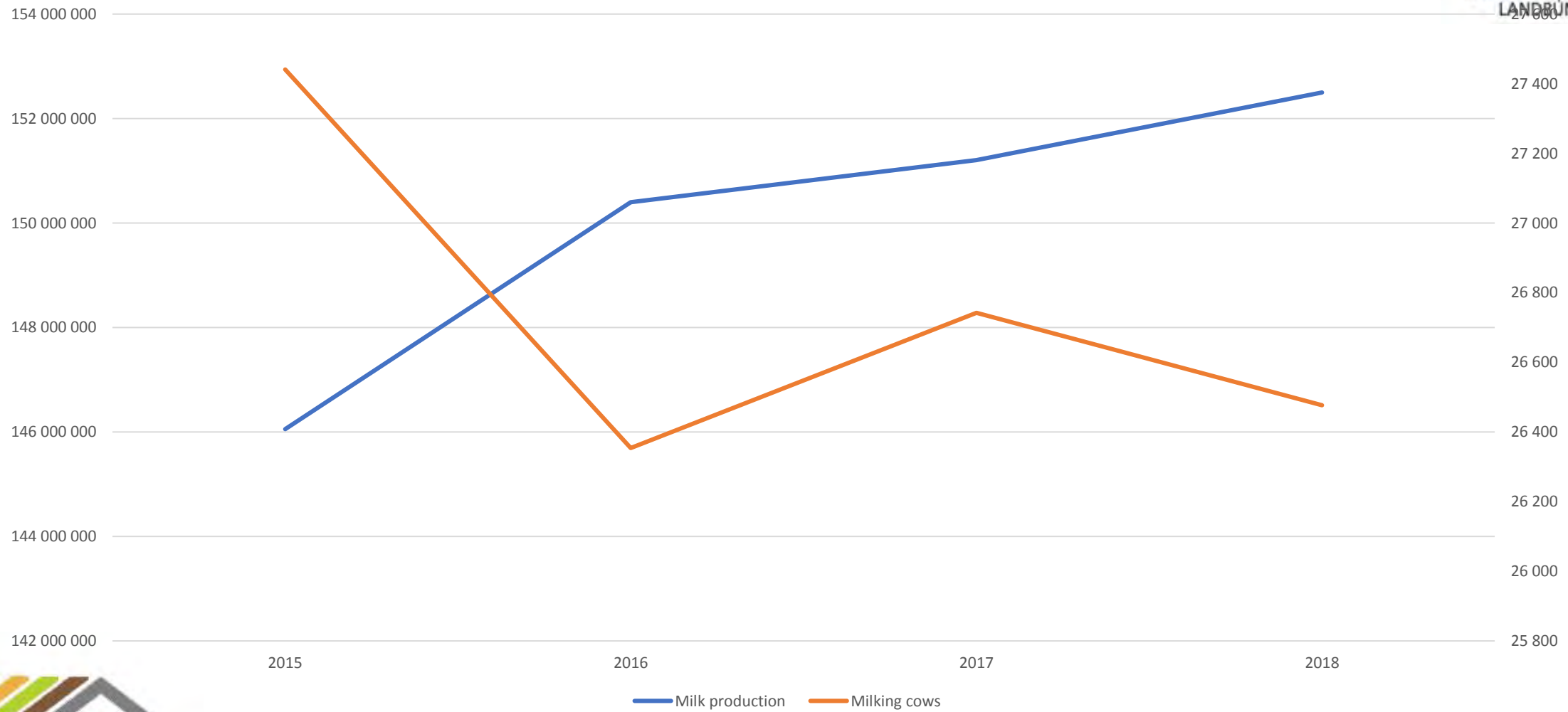

— Milk production — Milking cows

Barn type

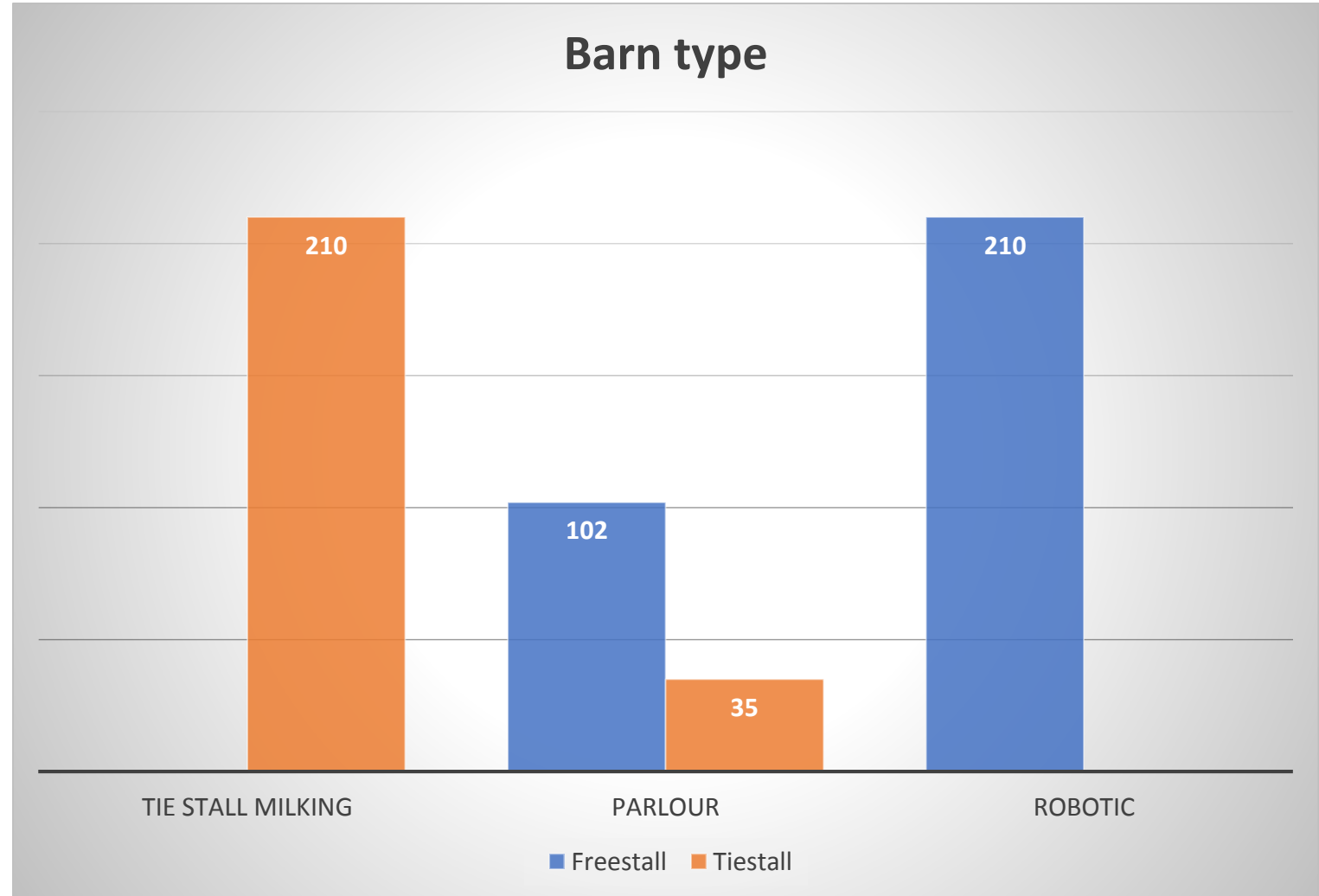

Milking robots

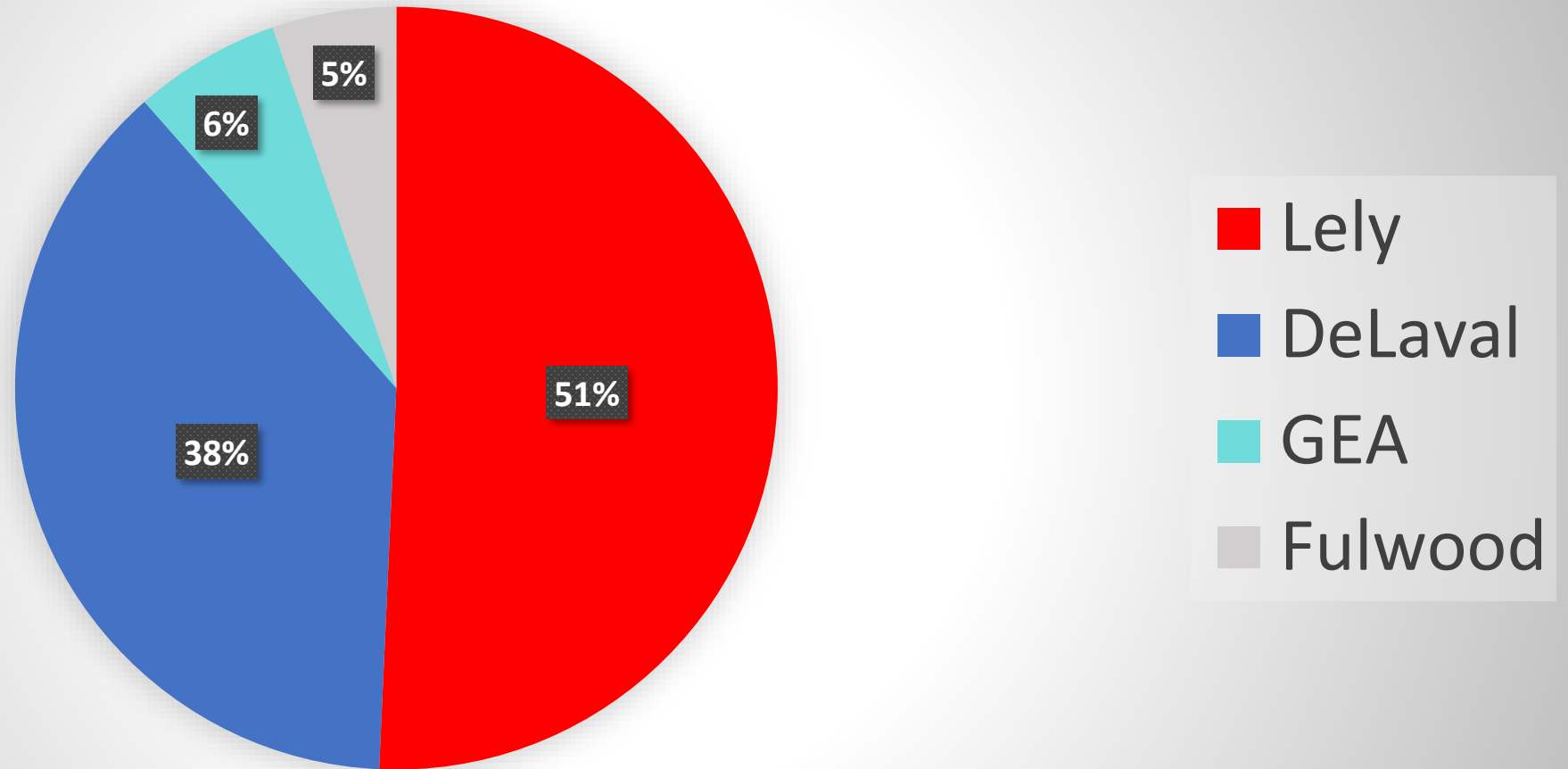

Constructions in dairy and beef industry

- In 2018 126 farmers got grants from the government to either build a new barn or make existing barn bigger and/or better
- Most of the buildings are natural ventilated and nearly all insulated
- Mostly
 - Rubber mats in cubicles
 - Slatted floors for heifers
 - Cellar under buildings or deep canals



Beef Cattle

- Imported Angus embryos starting starting to spread there DNA this month
 - 30% of todays beef cattle are in P+ 4,79 €/kg
 - 1% goes to R+ 5,75 €/kg
 - 105 € are payed from the goverment on each slaughtered beef cattle
 - 48,74 €/year is payed for living beef cow



Pigs

- 10 pig farms are in Iceland
 - 3.323 adult pigs
 - 81.442 slaughtered
 - 6.796 ton produced 2018
 - Payered 3,35 €/kg (65-90 kg)
- Big plans are to increase the industry because of demand
- Ideas are to start with active-stall concept for finishers and spread them to sheep farms with empty buildings

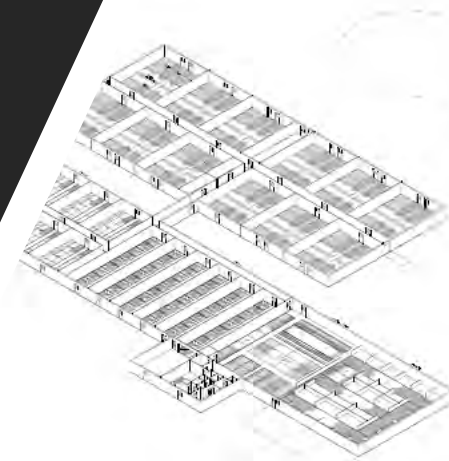

400 sows, full line Preliminary drawing

Tegning:

- 101 Overall view
- 102 Overall 3D view
- 103 Slurry channels - Overall view
- 111 Finisher - Plan view
- 112 Finisher - Plan view, slurry channels
- 113 Finisher - Cross section A-A
- 121 Weaner / Farrow - Plan view
- 122 Weaner / Farrow - Plan view, slurry channels
- 123 Weaner - Cross section B-B and C-C
- 124 Farrow - Cross section D-D and E-E
- 131 Mating / Boar / Gestation - Plan view



Poultry

- 20 Broiler farm (1 built in 2018)
- 5,6 million broilers slaughtered
- 9,500 ton

- 11 egg farms
 - 37% free range
 - 6% access to outdoor area
 - 57% in cages (will be banned in 2021)



Horses

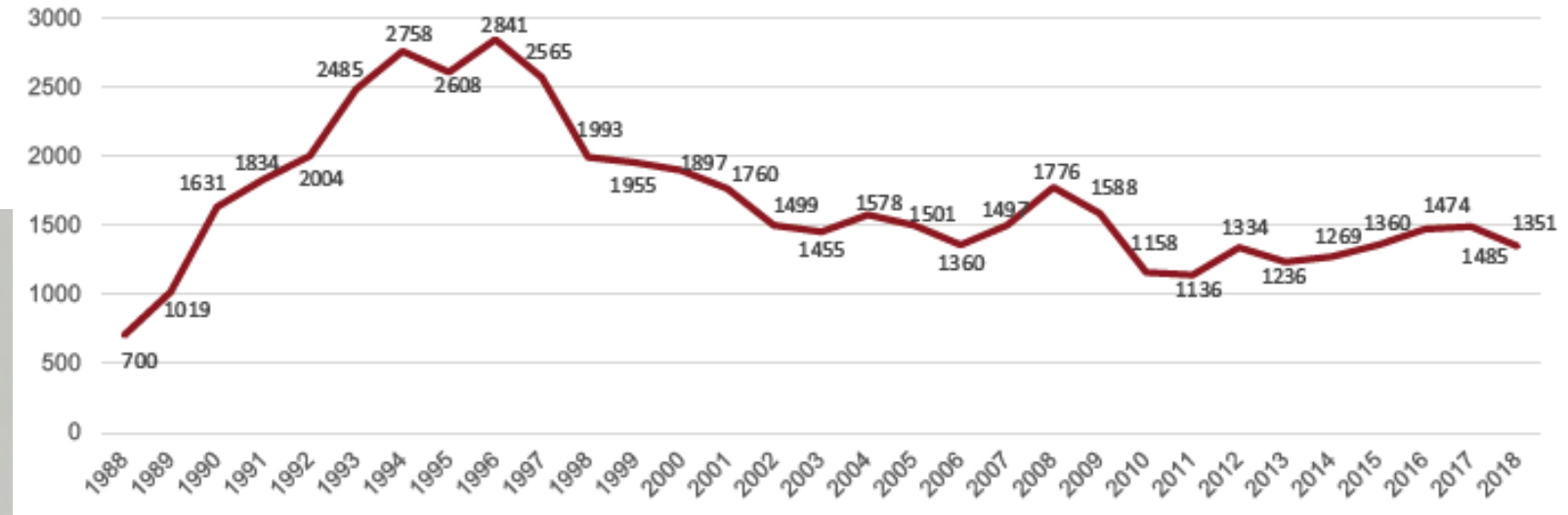

- 53.136 horses
- 3.075 registered owner/farms
- 1.351 horse was sold out of the country
 - Mostly to Germany and Sweden

- 7.614 slaughtered
 - 939 tons
 - 0,61 €/kg (2-4 winter old)

Almost Carbon neutral meat?



Sheep

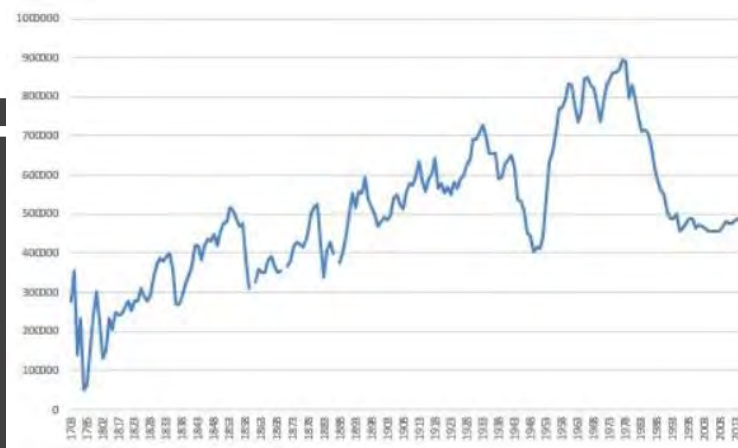

- 423.748 sheep winterfeed
- 600.508 slaughtered
- 10.487 tons



Sheep

- 600.508 slaughtered
- 10.487 tons
- 3,21 €/kg
- Increase from last Byggtræff

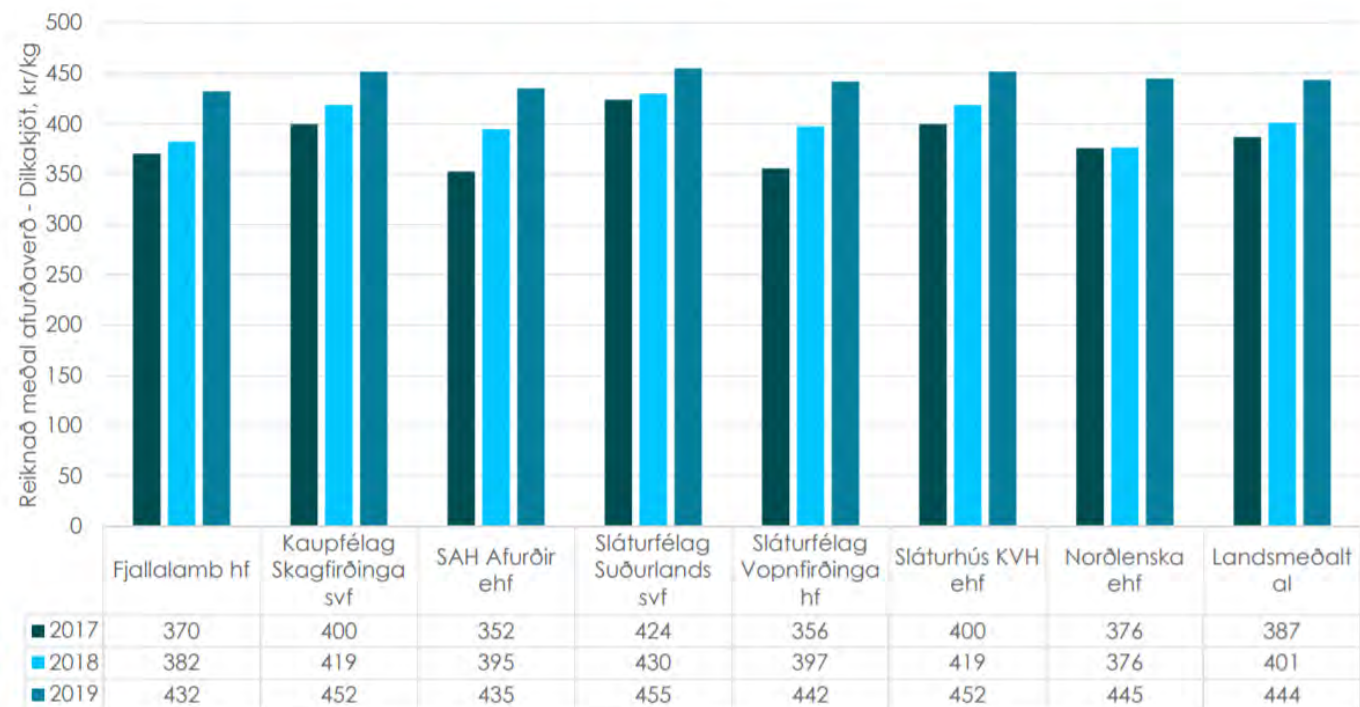

Trends and challenges

- If qouta will be on a free market we will see a big reduce in number of farms and the ones left will get bigger 2-3 robot farms
- The price of lamb has risen and farmers are grant for stop producing lamb meat if that works the production and price will be ok



Trends and challenges

- Plastic is something farmers use a lot of in Iceland
 - 1.800 ton/year in total
- We at RML have started a project to see if its feasible to do as many Canadians and use tower silos
 - Easy to automat e.t.c.



Changes around the corner

Maybe our biggest threat is the
changes in eating habits

Mostly because of climate issues
also animal welfare

Hlutfall ungra kvenna (18-24 ára) sem segjast aldrei borða svínakjöt, lambakjöt, nautakjöt eða kjúkling

